



HIGH PRESSURE BALL VALVE 2007W36



FEATURES

- 1/4"~2" (DN8~DN50)
 - W.P. : 3600 WOG (PN250)
 - W.T. : -20°C~260°C (-4°F~500°F)
 - Investment casting
 - Blow-out proof stem
 - Anti-static device (option)
 - Locking device
 - ISO 5211 Mounting pad
 - Seal welded ends
 - ASME B16.34 Wall thickness
 - NACE MR0175
 - API 607 Fire safe approved
- Thread type : ASME B1.20.1 (NPT)
DIN2999 & BS21
ISO7/1 & EN10226

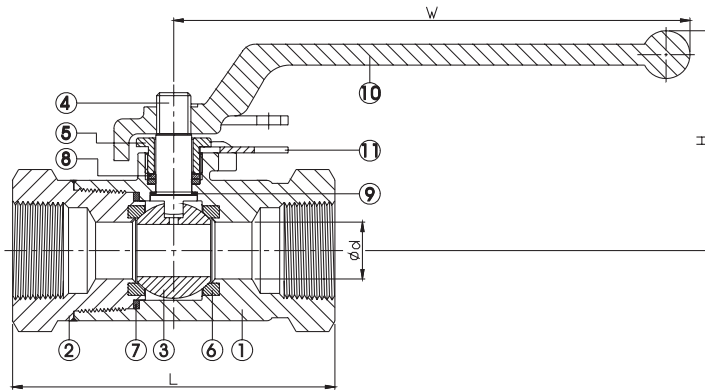
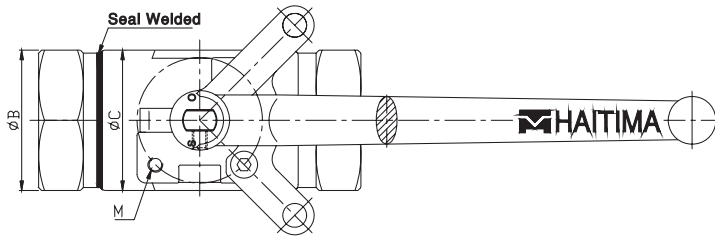

ITEM	PARTS	MATERIAL	
1	BODY	ASTM A351-CF8M	ASTM A216-WCB
2	CAP		
3	BALL	ASTM A351-CF8M	
4	STEM	ASTM A276-316	
5	GLAND NUT	AISI 304	
6	SEAT	PEEK	
7	SEAL	GRAPHITE	
8	PACKING		
9	THRUST WASHER	CTFE	
10	HANDLE	AISI 304	
11	LOCKING PAD		

DN	L	H	W	d	B	C	ISO 5211	M	Torque (N-M)	Weight (kg)
8 F	76.2	56.6	142	6.35	32	39	F03	M5*P0.8	9.5	0.7
15 F	101.6	56.6	142	12.7	32	39	F03	M5*P0.8	9.5	0.8
20 F	108	76.1	173	19	47	47	F04	M5*P0.8	28	1.3
25 S	108	76.1	173	19	47	47	F04	M5*P0.8	28	1.3
40 F	134	117	247.5	38.1	77	86	F07	M8*P1.25	53	4.9
50 S	158.1	117	247.5	38.1	82	86	F07	M8*P1.25	53	5.4

F: Full Port S: Standard Port

unit:mm

NPS	L	H	W	d	B	C	ISO 5211	M	Torque (in-lb)	Weight (lb)
1/4" F	3	2.23	5.59	0.25	1.26	1.54	F03	M5*P0.8	84.1	1.5
1/2" F	4	2.23	5.59	0.5	1.26	1.54	F03	M5*P0.8	84.1	1.7
3/4" F	4.25	3	6.81	0.75	1.85	1.85	F04	M5*P0.8	247.8	3
1" S	4.25	3	6.81	0.75	1.85	1.85	F04	M5*P0.8	247.8	2.8
1-1/2" F	5.28	4.61	9.74	1.5	3.03	3.39	F07	M8*P1.25	469.1	10.8
2" S	6.22	4.61	9.74	1.5	3.23	3.39	F07	M8*P1.25	469.1	11.8

F: Full Port S: Standard Port

unit:in



8F., No.201, Sec. 2, Tiding Blvd., Neihu District, Taipei City 114, Taiwan R.O.C.
TEL : +886-2-2658-5800 FAX : +886-2-2658-2266 / 2799-7766

[Http://www.haitima.com.tw](http://www.haitima.com.tw)
E-mail : haitima@seed.net.tw