

DN	d	L	H	H1	H2	S	N1	M1	ISO 5211
50	42	43	110	51	14	11	4	9	F07
65	58	46	120	51	14	11	4	9	F07
80	81	48	130	51	16	14	4	9	F07
100	108	54	144.5	51	16	14	4	9	F07
125	132	56	165	51	19	14	4	9	F07
150	156	57	182.5	51	25	17	4	9	F07
200	203	64	218	51	25	17	4	9	F07
250	252	71	267.5	65.5	30	22	4	11	F10
300	304	81	284	65.5	30	22	4	11	F10
350	334	92	330	80	40	36	4	17	F14
400	378	102	362.5	80	40	36	4	17	F14
450	437	114	437.5	100	50	36	4	17	F14
500	475	127	430	140	50	46	4	21	F16
600	578	154	502	140	50	46	8	M16	F25

unit:mm

NPS	d	L	H	H1	H2	S	N1	M1	ISO 5211
2"	1.65	1.69	4.33	2.01	0.55	0.43	4	0.35	F07
2-1/2"	2.28	1.81	4.72	2.01	0.55	0.43	4	0.35	F07
3"	3.19	1.89	5.12	2.01	0.63	0.55	4	0.35	F07
4"	4.25	2.13	5.69	2.01	0.63	0.55	4	0.35	F07
5"	5.2	2.2	6.5	2.01	0.75	0.55	4	0.35	F07
6"	6.14	2.24	7.19	2.01	0.98	0.67	4	0.35	F07
8"	7.99	2.52	8.58	2.01	0.98	0.67	4	0.35	F07
10"	9.92	2.8	10.53	2.58	1.18	0.87	4	0.43	F10
12"	11.97	3.19	11.18	2.58	1.18	0.87	4	0.43	F10
14"	13.15	3.62	12.99	3.15	1.57	1.42	4	0.67	F14
16"	14.88	4.02	14.27	3.15	1.57	1.42	4	0.67	F14
18"	17.2	4.49	17.22	3.94	1.97	1.42	4	0.67	F14
20"	18.7	5	16.93	5.51	1.97	1.81	4	0.83	F16
24"	22.76	6.06	19.76	5.51	1.97	1.81	8	M16	F25

unit:in

ITEM	PARTS	MATERIAL
1	BODY	ASTM A351-CF3M ASTM A351-CF8M ASTM A351-CF8 ASTM A216-WCB
2	DISC	ASTM A351-CF3M / ASTM A351-CF8M / ASTM A351-CF8
3	CLAMP RING	
4	SHAFT	316L / 316 / 304 / 17-4PH
5	SEAT	RTFE / 316+GRAPHITE / 304+GRAPHITE
6	GLAND FLANGE	ASTM A351-CF8M / ASTM A351-CF8
7	BEARING	316+PTFE
8	BEARING	
9	TAPER PIN	316L / 316 / 304
10	BOTTOM COVER	ASTM A351-CF8M / ASTM A351-CF8
11	SHAFT SEAL	GRAPHITE
12	BOTTOM COVER SEAL	
13	STEN POSITION	316 / 304
14	SEAL	GRAPHITE

The pressure rating follow According to user needs

*Double Eccentric

△			
△			
△			
Revise	Description	Date	Approve



HAITIMA CORPORATION

CHECK BY	DRAWING BY	DATE	SPECIFICATION	Double Eccentric Lug Type Butterfly Valve
	Ray	Feb.22.2021	MATERIAL	CF3M/CF8M/CF8/WCB
			PROCESS/Nr.	
			UNIT / SCALE	mm

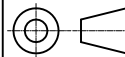

DRAWING NO.

2014HD-L000KY-21

HAITIMA CORPORATION
 P.O.BOX 34-36 TAIPEI
 Tel:+886-2-26585800
 E-mail:haitima@seed.net.tw
 www.haitima.com.tw
 TAIWAN R.O.C.
 Fax:+886-2-26582266