

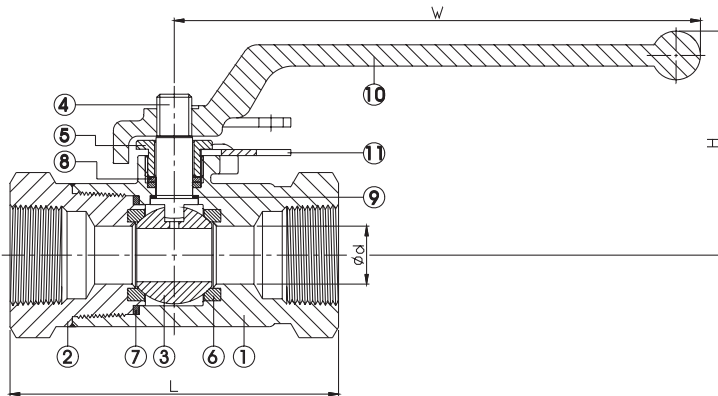

## FEATURES

- 1/4"~2" (DN8~DN50)
  - W.P. : 6000 WOG (PN420)
  - W.T. : -20°C~260°C (-4°F~500°F)
  - Investment casting
  - Blow-out proof stem
  - Anti-static device (option)
  - Locking device
  - ISO 5211 Mounting pad
  - Seal welded ends
  - ASME B16.34 Wall thickness
  - NACE MR0175
  - API 607 Fire safe approved
- Thread type : ASME B1.20.1 (NPT)  
DIN2999 & BS21  
ISO7/1 & EN10226

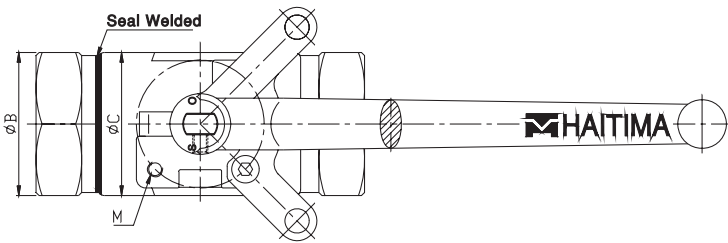

ITEM	PARTS	MATERIAL	
1	BODY	ASTM A351-CF8M	ASTM A216-WCB
2	CAP		
3	BALL	ASTM A351-CF8M	
4	STEM	ASTM A276-316	
5	GLAND NUT	AISI 304	
6	SEAT	PEEK	
7	SEAL	GRAPHITE	
8	PACKING		
9	THRUST WASHER	CTFE	
10	HANDLE	AISI 304	
11	LOCKING PAD		

DN	L	H	W	d	B	C	ISO 5211	M	Torque (N-m)	Weight (kg)
8 F	76.2	56.6	142	6.35	32	39	F03	M5*P0.8	9	0.7
10 S	76.2	56.6	142	6.35	32	39	F03	M5*P0.8	9	0.7
15 F	101.6	56.6	142	12.7	38	39	F03	M5*P0.8	9	0.9
20 F	108	76.1	173	19	47	52	F04	M5*P0.8	27.1	1.6
25 S	108	76.1	173	19	55	55	F04	M5*P0.8	27.1	2.7
25 F	122	83.1	173	25.4	55	68	F05	M6*P1	33.3	1.8
40 F	134	117	247.5	38.1	77	97	F07	M8*P1.25	51.4	6.1
50 S	158.1	117	247.5	38.1	92	97	F07	M8*P1.25	51.4	7.4

F:Full Port S:Standard Port

unit:mm

NPS	L	H	W	d	B	C	ISO 5211	M	Torque (in-lb)	Weight (lb)
1/4" F	3	2.23	5.59	0.25	1.26	1.54	F03	M5*P0.8	80	1.5
3/8" S	3	2.23	5.59	0.25	1.26	1.54	F03	M5*P0.8	80	1.5
1/2" F	4	2.23	5.59	0.5	1.5	1.54	F03	M5*P0.8	80	2
3/4" F	4.25	3	6.81	0.75	1.85	2.05	F04	M5*P0.8	240	3.4
1" S	4.25	3	6.81	0.75	2.17	2.17	F04	M5*P0.8	240	5.9
1" F	4.8	3.27	6.81	1	2.17	2.68	F05	M6*P1	295	4
1-1/2" F	5.28	4.61	9.74	1.5	3.03	3.82	F07	M8*P1.25	455	13.4
2" S	6.22	4.61	9.74	1.5	3.62	3.82	F07	M8*P1.25	455	16.3

F:Full Port S:Standard Port

unit:in

