

0.1	▽	Ra
0.2	▽▽	JIS
1.6	▽▽▽	
6.3	▽▽▽▽	
25	▽▽▽▽▽	
▽	▽	

±0.1	±0.22
±0.3	±0.5
±0.8	±0.8
0.5~5	31~120
6~30	121~320
GENERAL TOLERANCE	321~1000

HAITIMA CORPORATION
 P.O.BOX 34-36 TAIPEI
 Tel:+886-2-26585800
 E-mail:haitima@seed.net.tw
 www.haitima.com.tw
 TAIWAN R.O.C.
 Fax:+886-2-26582266

PART E

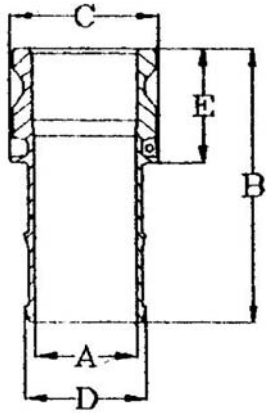

Size	1/2"	3/4"	1"	1-1/4"	1-1/2"	2"	2-1/2"	3"	4"	6"
Size of Shank	1/2"	3/4"	1"	1-1/4"	1-1/2"	2"	2-1/2"	3"	4"	6"
C: Max O.D.	30.3	35	38	48	55.4	65.3	79.5	93.5	121.5	179
B: Overall Length	86.5	86.3	107.47	109.5	113	129.58	149.5	166.6	174.5	238.5
E: Exposed Length	42	35.5	48.6	51.5	54	59.5	61.5	65	66.5	75
A: Min. I.D.	7.8	13.8	19.8	25.9	32.3	44.5	56.7	68	93.4	144.8
D: Shank O.D.	14.6	21	27	33.7	40.1	52.7	66.3	79	104.4	156.8

unit:mm



CHECK BY	DRAWING BY	DATE	SPECIFICATION	Cam & Groove Couplers & Adapters
	Sammy	Apr.21.2014	MATERIAL	SS 316
			PROCESS/Nr.	
			UNIT / SCALE	mm

△			
△			
△			
Revise	Description	Date	Approve
DRAWING NO. FK-06		-14	