

0.1	▽	Ra
0.2	▽	
1.6	▽	
6.3	▽	
25	▽	
0.1	~	JIS

0.5~5	± 0.1
6~30	± 0.2
31~120	± 0.3
121~320	± 0.5
321~1000	± 0.8

HAITIMA CORPORATION
 P.O.BOX 34-36 TAIPEI
 Tel:+886-2-26585800

E-mail:haitima@seed.net.tw
 TAIWAN R.O.C. www.haitima.com.tw
 Fax:+886-2-26582266

PART F

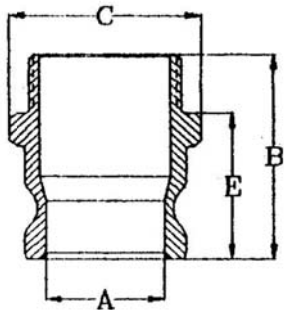

Size	1/2"	3/4"	1"	1-1/4"	1-1/2"	2"	2-1/2"	3"	4"	6"
Size of Thread	1/2"	3/4"	1"	1-1/4"	1-1/2"	2"	2-1/2"	3"	4"	6"
B: Overall Length	49	58	67.5	73.2	74.7	83.62	97	101	107.9	116.3
E: Exposed Length	34	39	48.5	52.5	54	61.7	68	70	74.6	79.2
A: Min I.D.	14.2	21	23.8	30.8	38.5	46	58	73.2	98.2	150
C: Max Across Corners of Adaptors	28.6	39.2	43.8	51.9	60.4	70.4	82.3	97.8	126.8	187.6

unit:mm



HAITIMA CORPORATION

CHECK BY

DRAWING BY

DATE

SPECIFICATION

Cam & Groove Couplers & Adaptors

Sammy

Apr.21.2014

MATERIAL

SS 316

PROCESS/Nr.

UNIT / SCALE

mm

△			
△			
△			
Revise	Description	Date	Approve
DRAWING NO.		-14	

FK-06